

WORM DRIVE & SCREW CLAMPS



Quick Release Worm Drive

HCL's Quick Release Worm Drive clamps offer a tilting Worm Drive housing. This is the ideal product for quick application, especially for large diameter pipes and hoses.

Applications

- Exhaust Fans
- Flexible Ducting
- HVAC
- General Industry

PERFORMANCE	Strength	<div><div></div><div></div><div></div></div>
	Temperature	<div><div></div><div></div><div></div><div></div></div>
	Speed	<div><div></div><div></div><div></div><div></div></div>
	Weathering	<div><div></div><div></div><div></div></div>
	Chemical	<div><div></div><div></div><div></div></div>
	Dynamic Range	<div><div></div><div></div><div></div><div></div></div>

Materials – see section 10.3

- W2** Screw & Cover – Zinc Plated Steel
Band & Housing – 430 SS

On Request

- W4** 304 SS

Weathering	<div><div></div><div></div><div></div></div>
Chemical	<div><div></div><div></div><div></div></div>

HCL Part No	Diameter Range (A) mm	Band Width (B) mm	Band Thickness (C) mm	Hex Screw A/F (D) mm	Max Torque Nm	Box Quantity
QR-100	25 – 100	9.0	0.6	7.0	4.0	100
QR-200	25 – 200					
QR-300	25 – 300					
QR-400	25 – 400					
QR-500	25 – 500					
QR-750	25 – 750					

All weights, dimensions & quantities are subject to a 2.5% tolerance.
To add material selection to the HCL Part No: for W2, add “W2”.
Other sizes available on request.

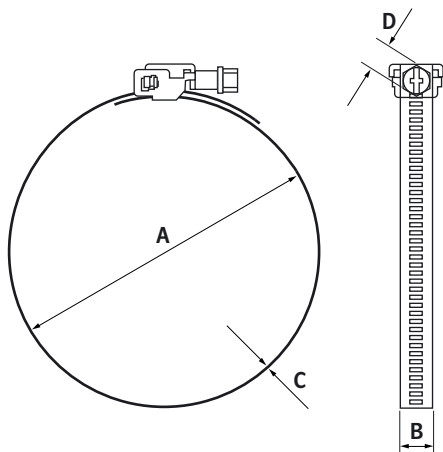

Installation Tools – see section 9.1

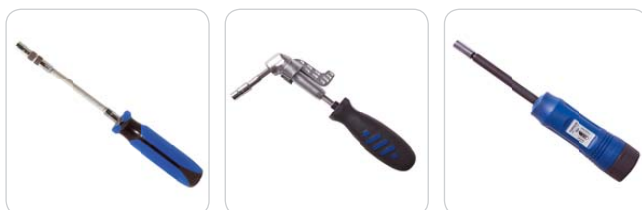

MT-D-01

MT-AD-01

MT-TD-01